

Product Data Sheet

Y54 Type 5 Valve Manifold

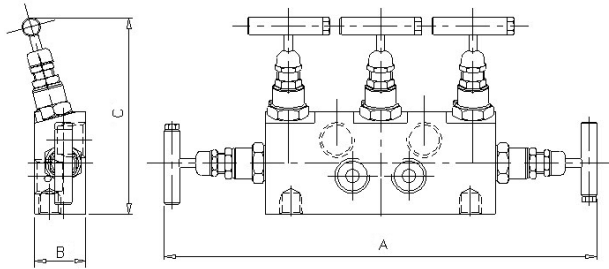

The 'Y54' Type 5 valve manifolds are designed for remote mounting to differential pressure transmitters, with separate isolation and vent for LP and HP inlets plus equalising valve for simple calibration. Each needle valve head is designed for safe and reliable isolation, giving bubble tight shut off, with non-rotating & anti-galling tip and dynamic self-adjusting spindle seal to give long service life in a variety of service conditions.

Part No.	Connections Size	A	B	C	Weight (Kgs)
Y54	½" F x F	10.6	1.3	4.8	2.3

Key Features of the Oliver Needle Valve range

- Non rotating tip - self centering & anti-galling
- Piston ring - gives dynamic adjustment of gland seal in response to pressure change
- Anti-blow out spindle - a major safety feature
- Secure seal - precision machined to give leak free operation for the life of the valve. Available in either PTFE or Grafoil

Standard Specification

Pressure: 6000psi	Packing: PTFE	Handle: T-Bar	Bore: 0.21" (5.4mm)
Temp: 240 deg C	Thread form: NPT	Seat: Metal to metal	CV: 0.46
1/2" Inlet and Outlet Connections		1/4" NPT Vent Connections	

Ordering Code

(Typical example) → **Y54** **S** / **BT** / **AT**

Type

Y54 - Female x Female

Material

S - 316S31 Stainless Steel
M - Monel (400)
HC - Hastalloy (C276)
(Others available)

Optional Connections (NPT Standard)

BT - BSP Taper
BP - BSP Parallel (top sealing)
BTV - BSP Taper Vent
BPV - BSP Parallel Vent
FSW - Female Socket Weld

Options

AG - Grafoil
AT - Anti-Tamper
BKTC - Carbon steel mounting bracket
BKTS - Stainless steel mounting bracket
HL - Handle Locking
HL-PI - Handle Locking + Position Indicator
HW - Hand Wheel
LT100 - Cryogenic Head Unit (-100°C)
MT - Metering Tip
MTG - Tapped Mounting Holes x 2
NA - NACE MR-01-75 (latest revision)
OXY - Oxygen Cleaned
PK - PEEK Soft Tip
PP - Blank Plug Fitted In Vent Connection

Rev 1.1